

Floor Plan - Lower Level 1



- SERVICE/SUPPORT
- ELEVATOR
- OFFICE

TOTAL: 164

LOWER LEVEL 01 PARKING 74

ADA CAR	2
ADA VAN	4
COMPACT	49
COMPACT TANDEM	2
STANDARD	14
STANDARD TANDEM	3

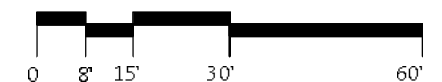
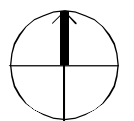

Floor Plan - Lower Level 2



- SERVICE/SUPPORT
- ELEVATOR
- OFFICE

TOTAL: 164

LOWER LEVEL 02 PARKING 90

COMPACT	60
COMPACT TANDEM	2
STANDARD	23
STANDARD TANDEM	5

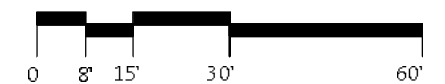
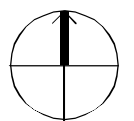

Floor Plan - Level 1

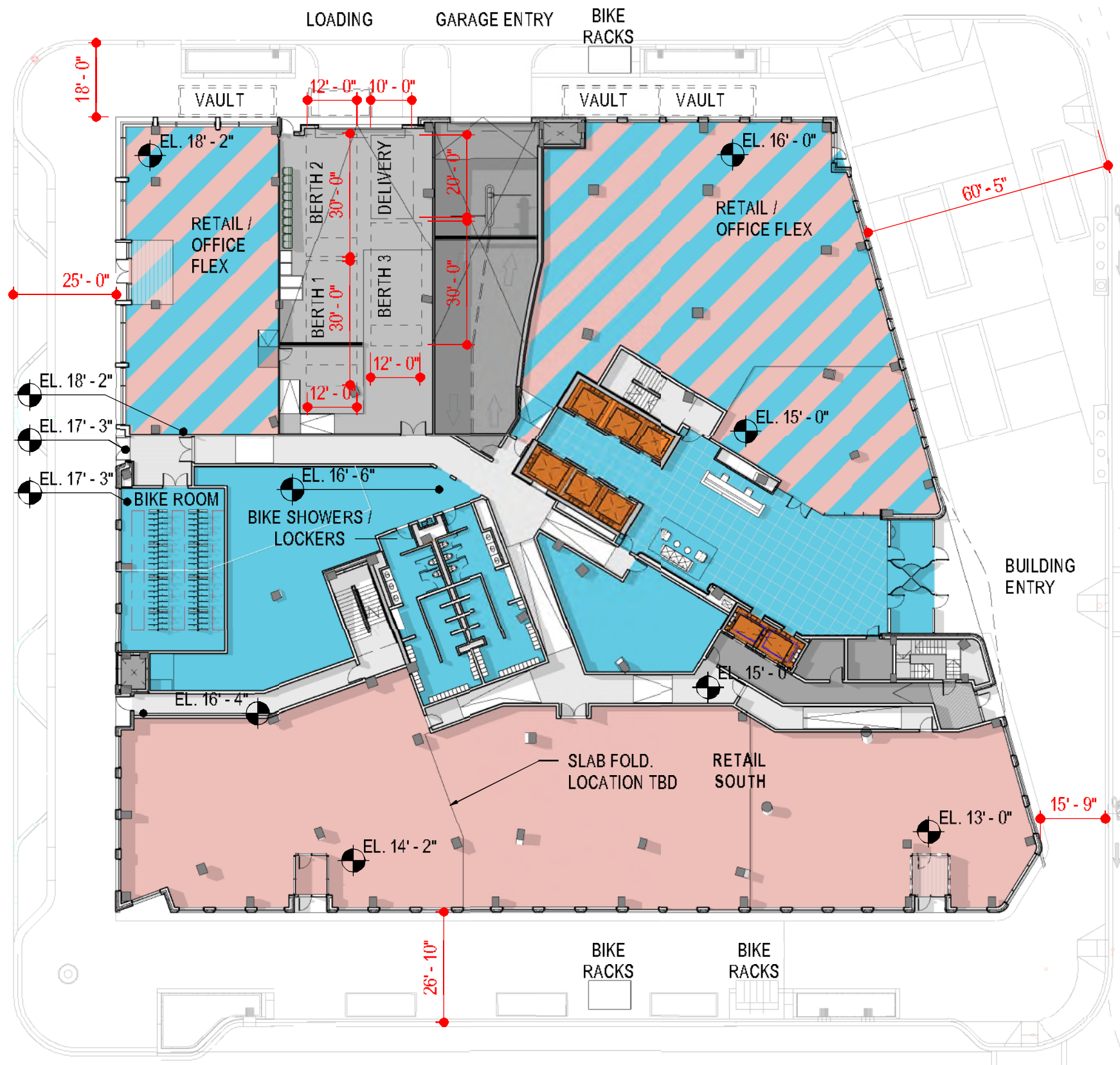

NOTES:

APPLICANT REQUESTS FLEXIBILITY TO VARY THE LOCATION AND DESIGN OF ALL INTERIOR COMPONENTS, INCLUDING PARTITIONS, STRUCTURAL SLABS, DOORS, HALLWAYS, COLUMNS, STAIRWAYS, AND MECHANICAL ROOMS, PROVIDED THAT THE VARIATIONS DON'T CHANGE THE EXTERIOR CONFIGURATION OF THE BUILDING.

- CIRCULATION
- SERVICE/SUPPORT
- ELEVATOR
- OFFICE
- RETAIL

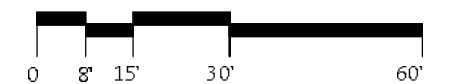
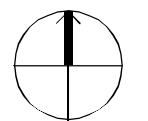

Floor Plan - Level 1 - Activation at New Jersey Avenue

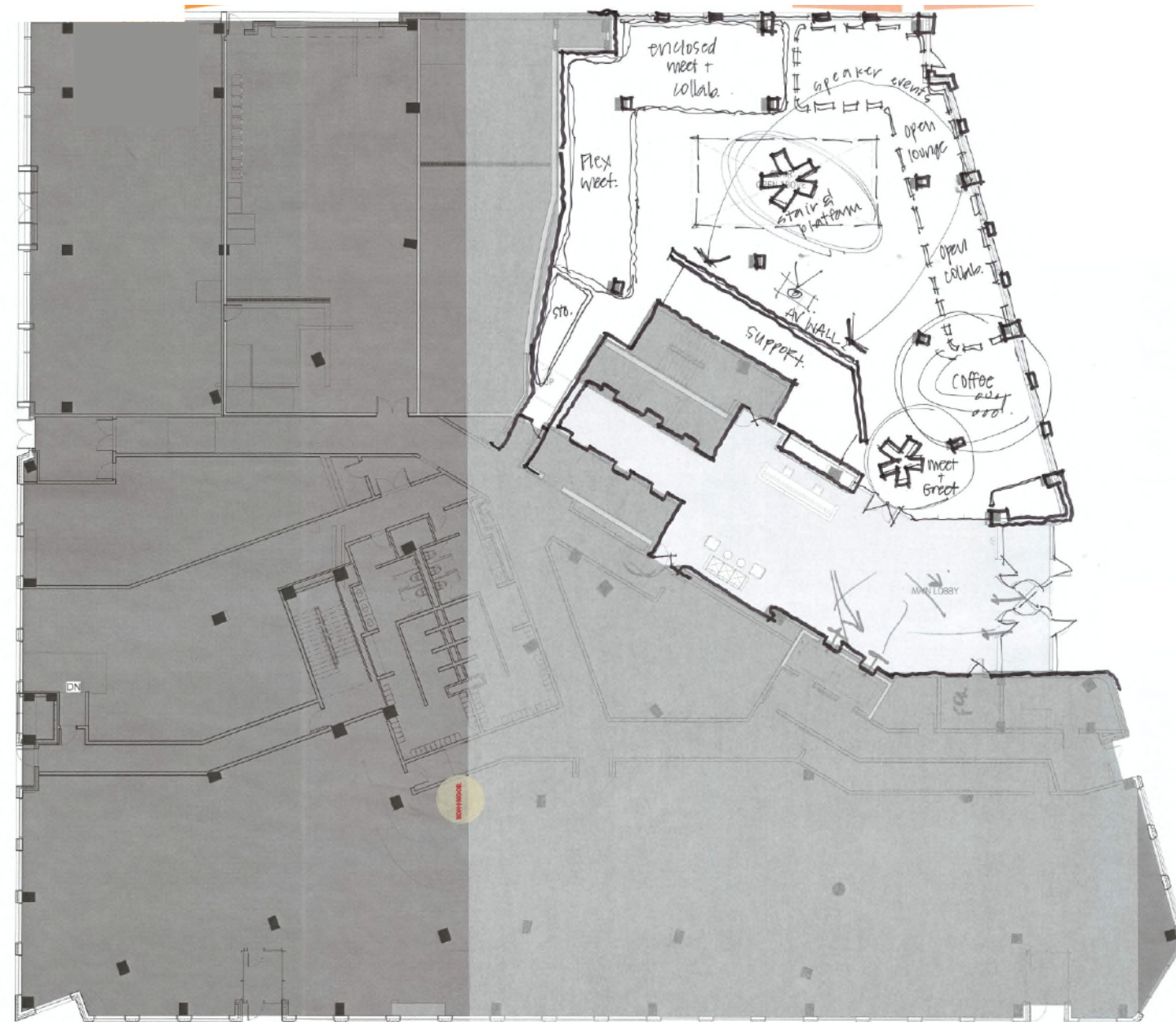

The lead office tenant for the building contemplates some or all of the following program elements to activate and energize the storefront presence along New Jersey Avenue:

- Reception & Coffee Area
- Stage with stepped seating for presentations and similar events
- Open interconnecting stair to Floor 02
- Enclosed meeting and collaboration space (located along Quander Street)

NOTES:

APPLICANT REQUESTS FLEXIBILITY TO VARY THE LOCATION AND DESIGN OF ALL INTERIOR COMPONENTS, INCLUDING PARTITIONS, STRUCTURAL SLABS, DOORS, HALLWAYS, COLUMNS, STAIRWAYS, AND MECHANICAL ROOMS, PROVIDED THAT THE VARIATIONS DON'T CHANGE THE EXTERIOR CONFIGURATION OF THE BUILDING.

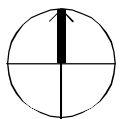

Level 1 - Activation at New Jersey Avenue - Reference Images





Floor Plan - Level 2

NOTES:

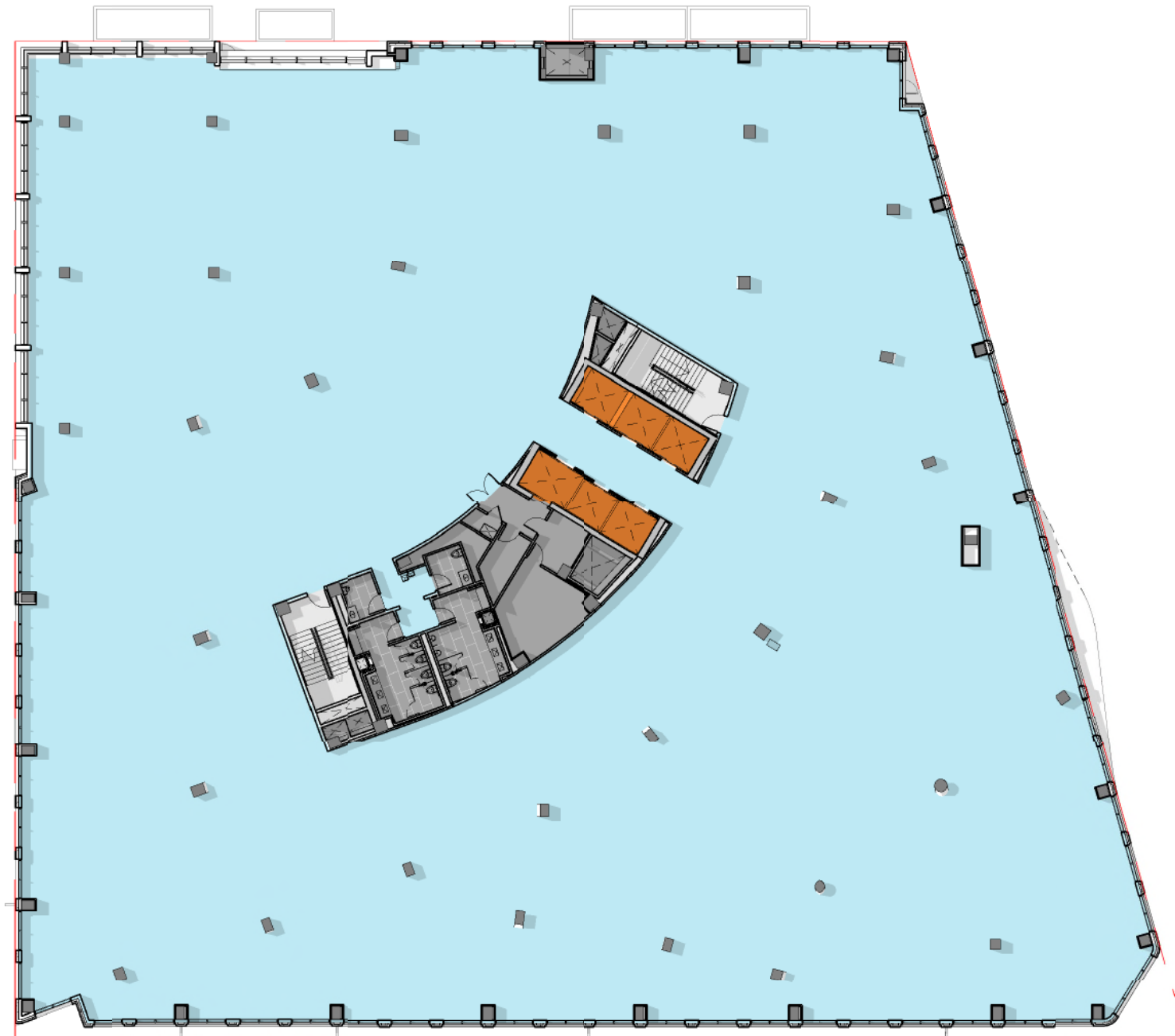
APPLICANT REQUESTS FLEXIBILITY TO VARY THE LOCATION AND DESIGN OF ALL INTERIOR COMPONENTS, INCLUDING PARTITIONS, STRUCTURAL SLABS, DOORS, HALLWAYS, COLUMNS, STAIRWAYS, AND MECHANICAL ROOMS, PROVIDED THAT THE VARIATIONS DON'T CHANGE THE EXTERIOR CONFIGURATION OF THE BUILDING.



-  CIRCULATION
-  SERVICE/SUPPORT
-  ELEVATOR
-  OFFICE

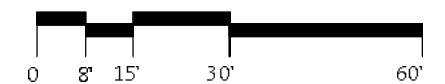
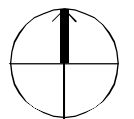



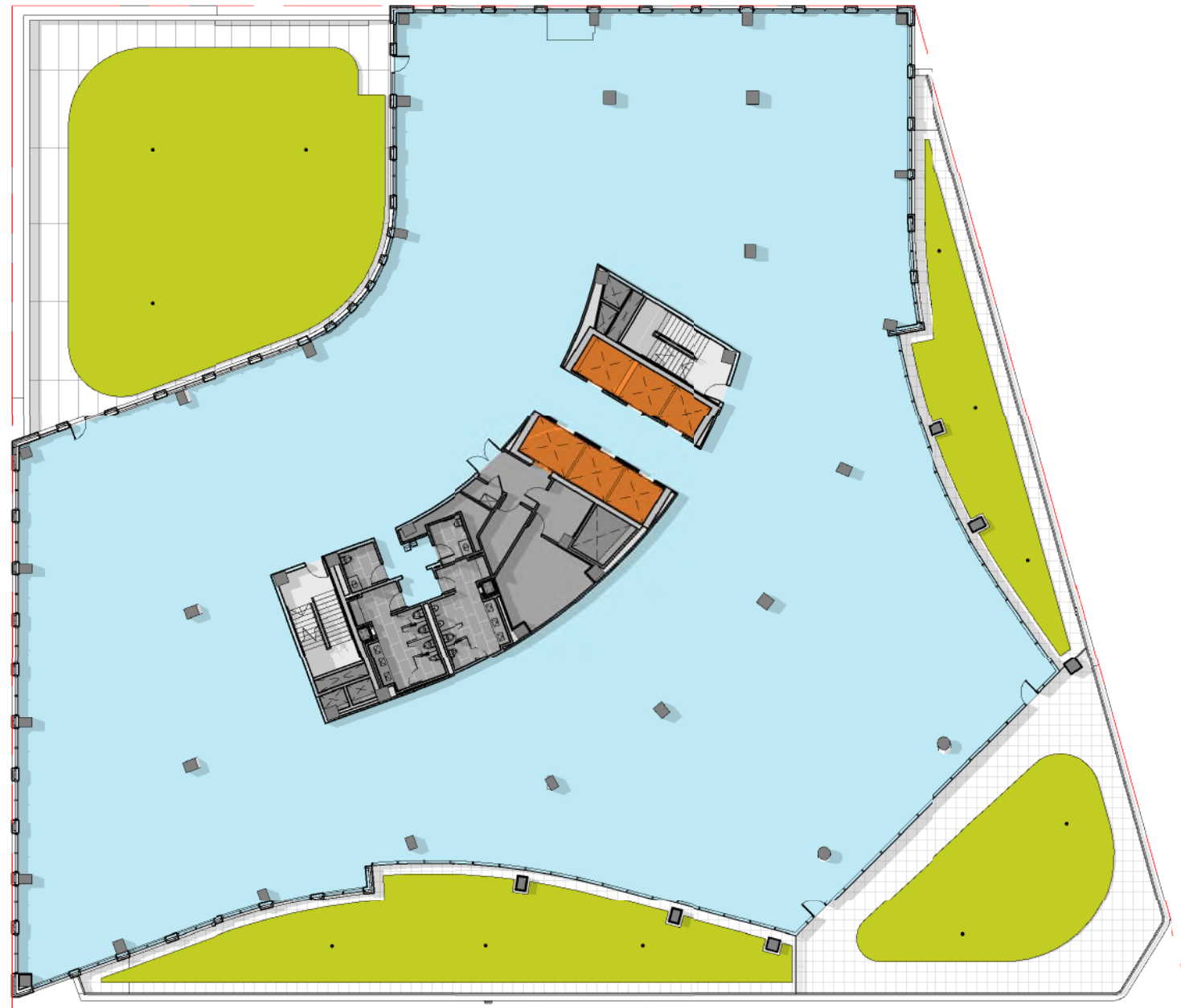

Floor Plan - Level 3

NOTES:

APPLICANT REQUESTS FLEXIBILITY TO VARY THE LOCATION AND DESIGN OF ALL INTERIOR COMPONENTS, INCLUDING PARTITIONS, STRUCTURAL SLABS, DOORS, HALLWAYS, COLUMNS, STAIRWAYS, AND MECHANICAL ROOMS, PROVIDED THAT THE VARIATIONS DON'T CHANGE THE EXTERIOR CONFIGURATION OF THE BUILDING.



-  CIRCULATION
-  SERVICE/SUPPORT
-  ELEVATOR
-  OFFICE
-  LANDSCAPE

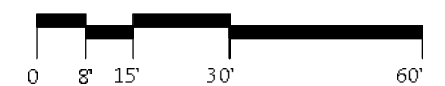
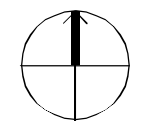

Floor Plan - Level 4 through Level 9

NOTES:

APPLICANT REQUESTS FLEXIBILITY TO VARY THE LOCATION AND DESIGN OF ALL INTERIOR COMPONENTS, INCLUDING PARTITIONS, STRUCTURAL SLABS, DOORS, HALLWAYS, COLUMNS, STAIRWAYS, AND MECHANICAL ROOMS, PROVIDED THAT THE VARIATIONS DON'T CHANGE THE EXTERIOR CONFIGURATION OF THE BUILDING.

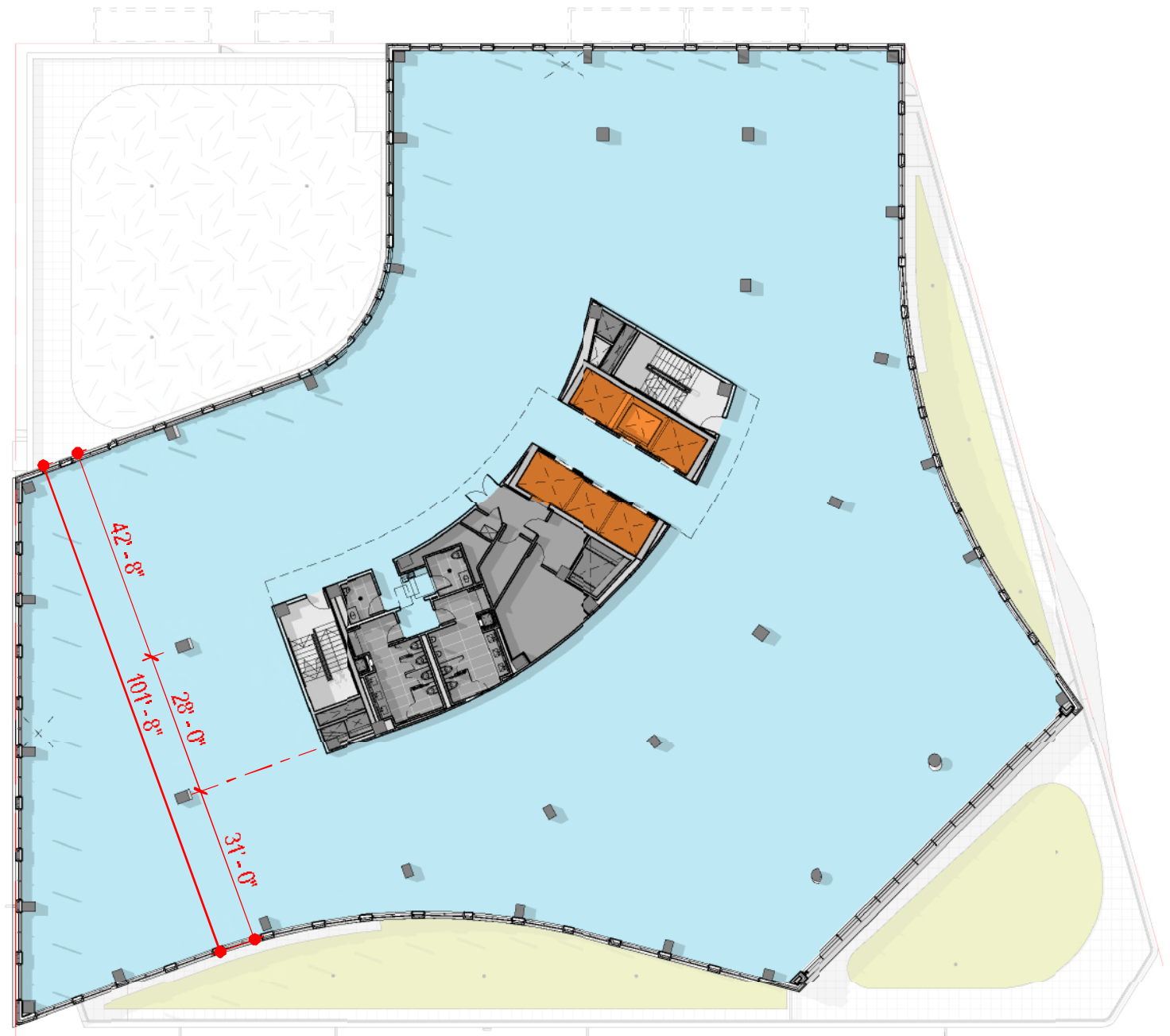

- CIRCULATION
- SERVICE/SUPPORT
- ELEVATOR
- OFFICE
- LANDSCAPE

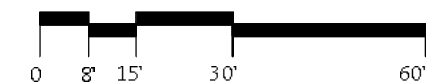
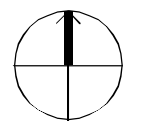

Floor Plan - Level 10

NOTES:

APPLICANT REQUESTS FLEXIBILITY TO VARY THE LOCATION AND DESIGN OF ALL INTERIOR COMPONENTS, INCLUDING PARTITIONS, STRUCTURAL SLABS, DOORS, HALLWAYS, COLUMNS, STAIRWAYS, AND MECHANICAL ROOMS, PROVIDED THAT THE VARIATIONS DON'T CHANGE THE EXTERIOR CONFIGURATION OF THE BUILDING.

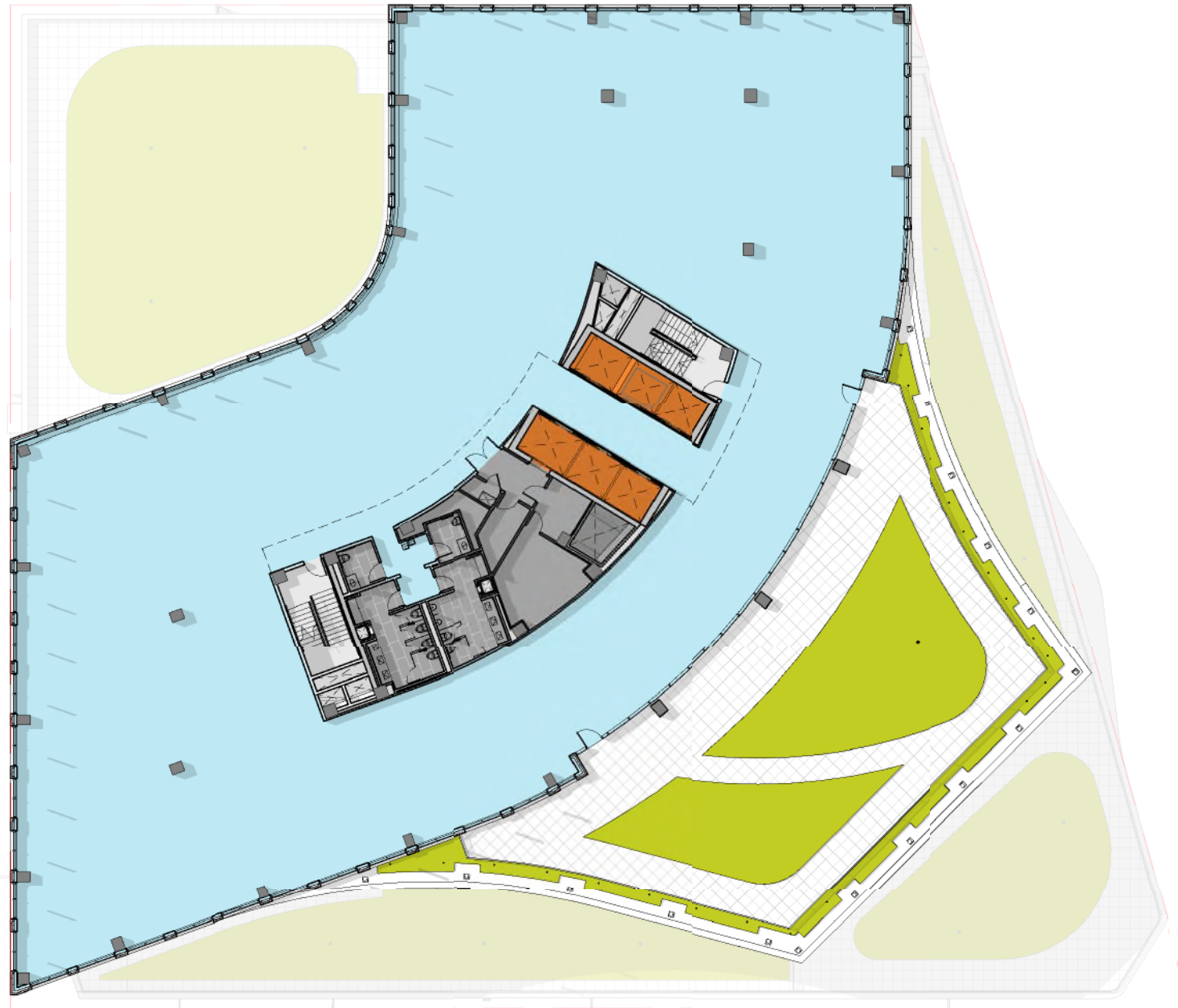



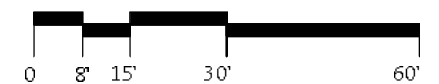
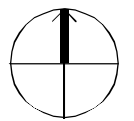

- CIRCULATION
- SERVICE/SUPPORT
- ELEVATOR
- OFFICE
- LANDSCAPE



Floor Plan - Level 11

NOTES:

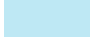
APPLICANT REQUESTS FLEXIBILITY TO VARY THE LOCATION AND DESIGN OF ALL INTERIOR COMPONENTS, INCLUDING PARTITIONS, STRUCTURAL SLABS, DOORS, HALLWAYS, COLUMNS, STAIRWAYS, AND MECHANICAL ROOMS, PROVIDED THAT THE VARIATIONS DON'T CHANGE THE EXTERIOR CONFIGURATION OF THE BUILDING.

-  CIRCULATION
-  SERVICE/SUPPORT
-  ELEVATOR
-  OFFICE
-  LANDSCAPE

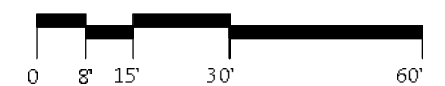
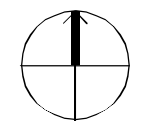
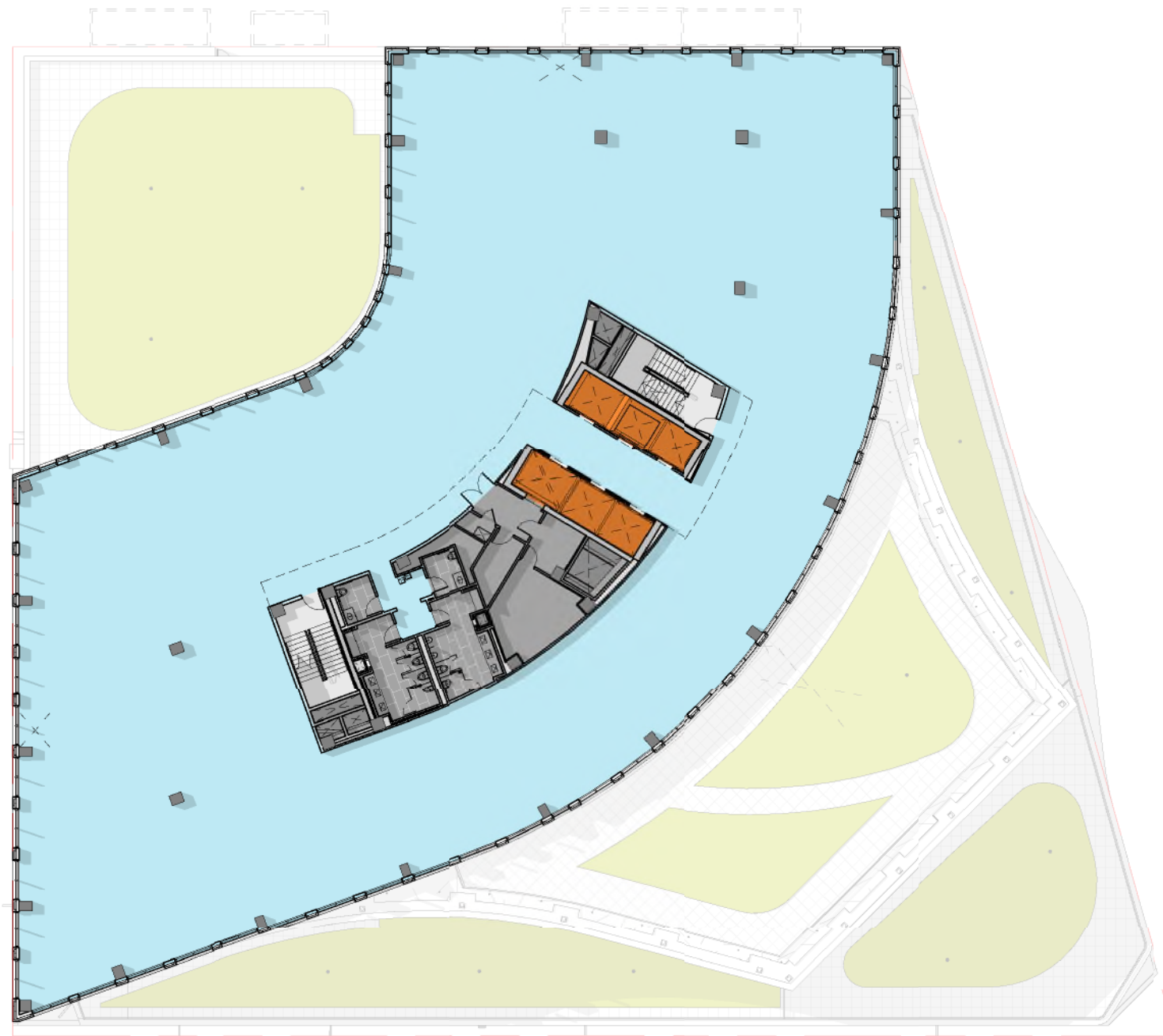

Floor Plan - Penthouse

NOTES:
 APPLICANT REQUESTS FLEXIBILITY TO VARY THE LOCATION AND DESIGN OF ALL INTERIOR COMPONENTS, INCLUDING PARTITIONS, STRUCTURAL SLABS, DOORS, HALLWAYS, COLUMNS, STAIRWAYS, AND MECHANICAL ROOMS, PROVIDED THAT THE VARIATIONS DON'T CHANGE THE EXTERIOR CONFIGURATION OF THE BUILDING.

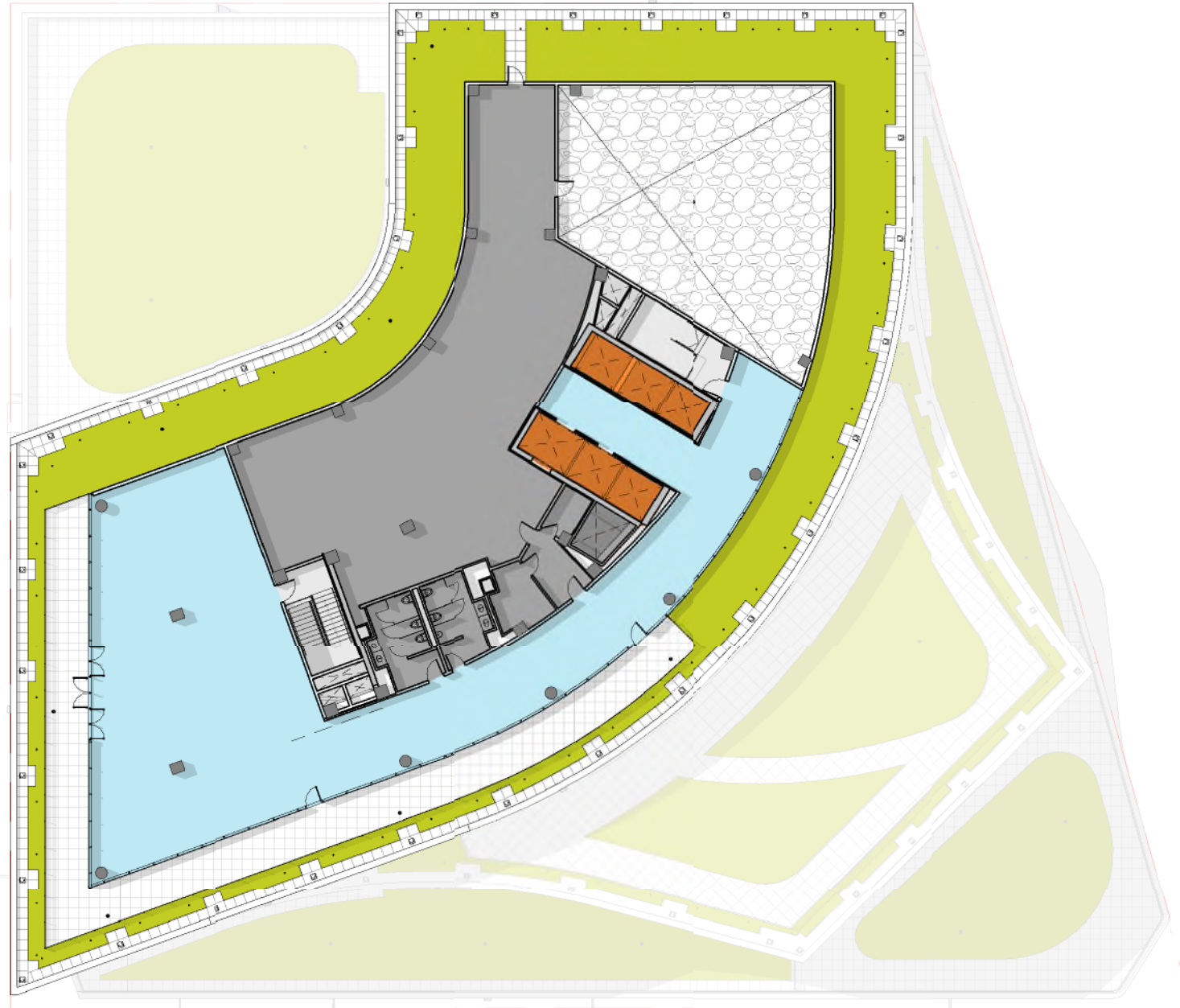

- CIRCULATION
- SERVICE/SUPPORT
- ELEVATOR
- OFFICE
- LANDSCAPE

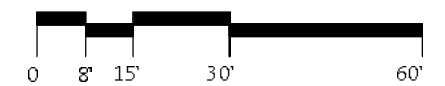
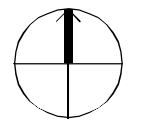

Roof Plan - Penthouse Roof

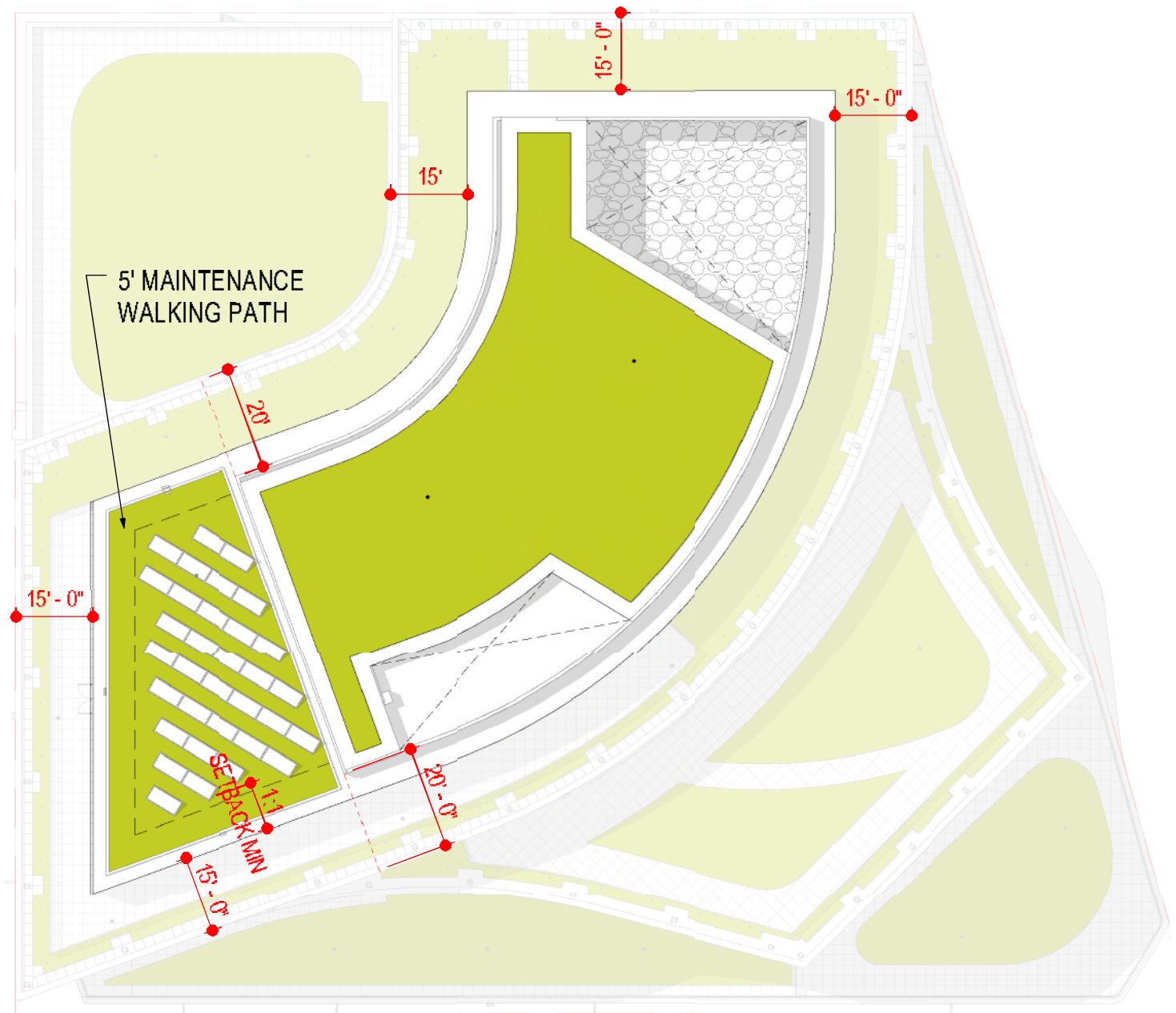

PV Panels

Square footage of roof area for panels & maintenance access: 2,300 sf

Number of Panels: 33

Approximate % of yearly energy usage: 0.5%

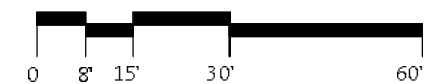
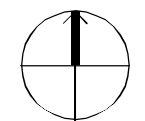

SECTION 4

DESIGN PROPOSAL
Elevations

Parcel Elevation - East

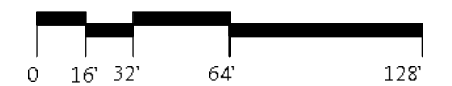
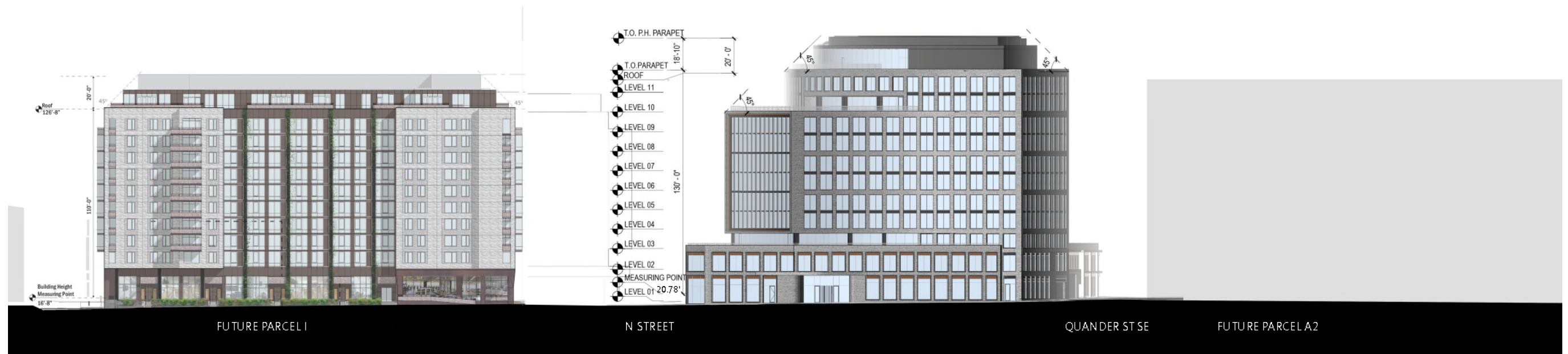
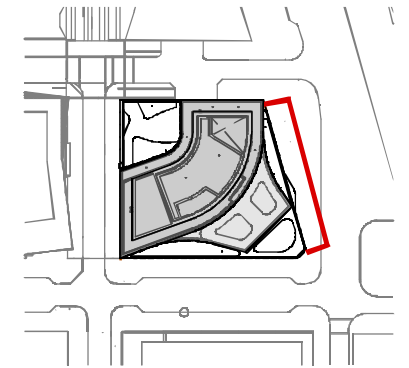

Parcel Elevation - South

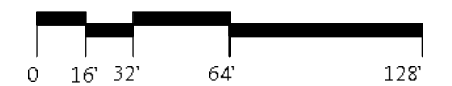
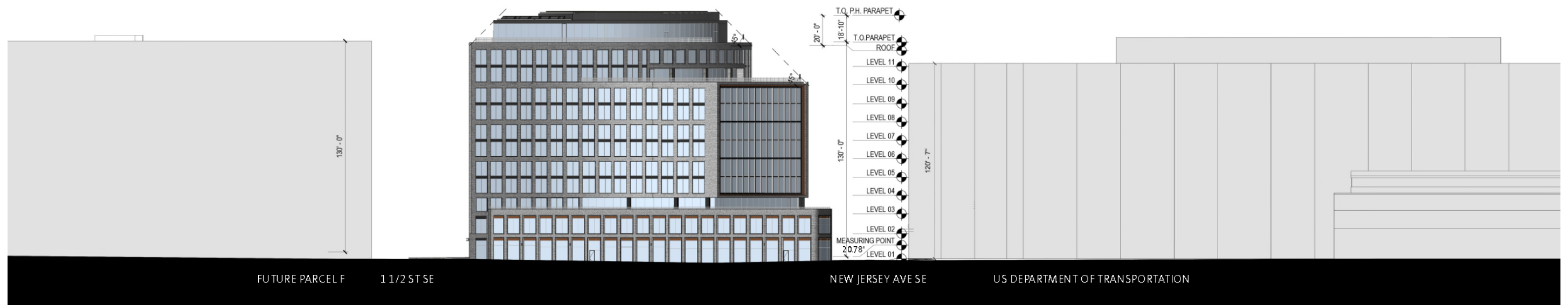
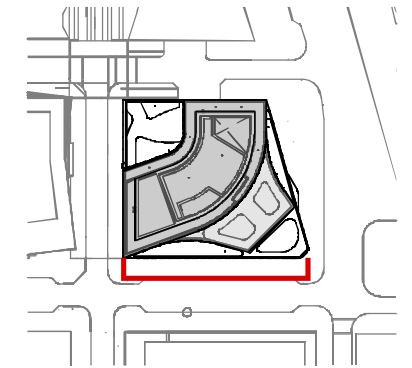

Building Elevation - North

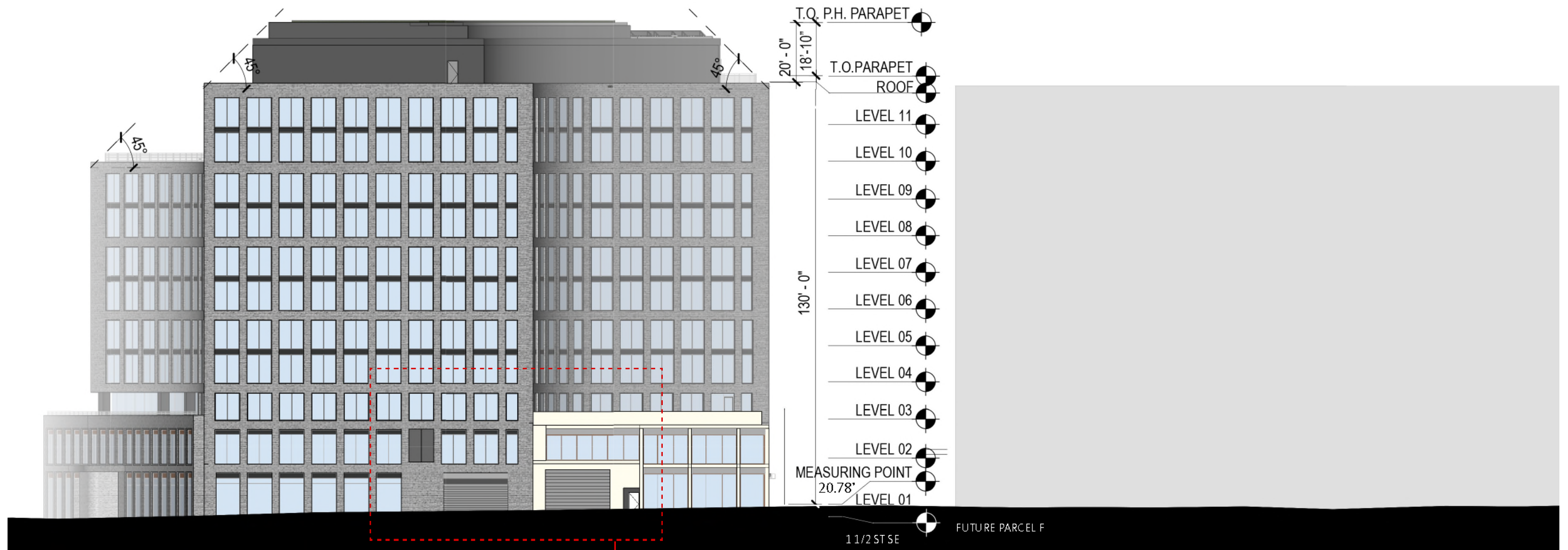
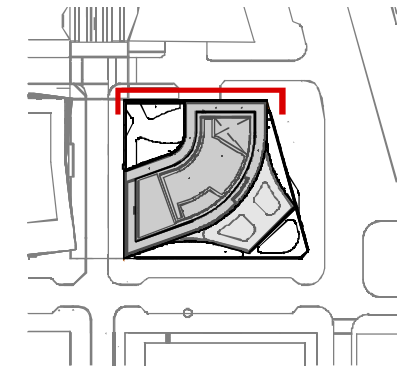

A
59



Building Elevation - East

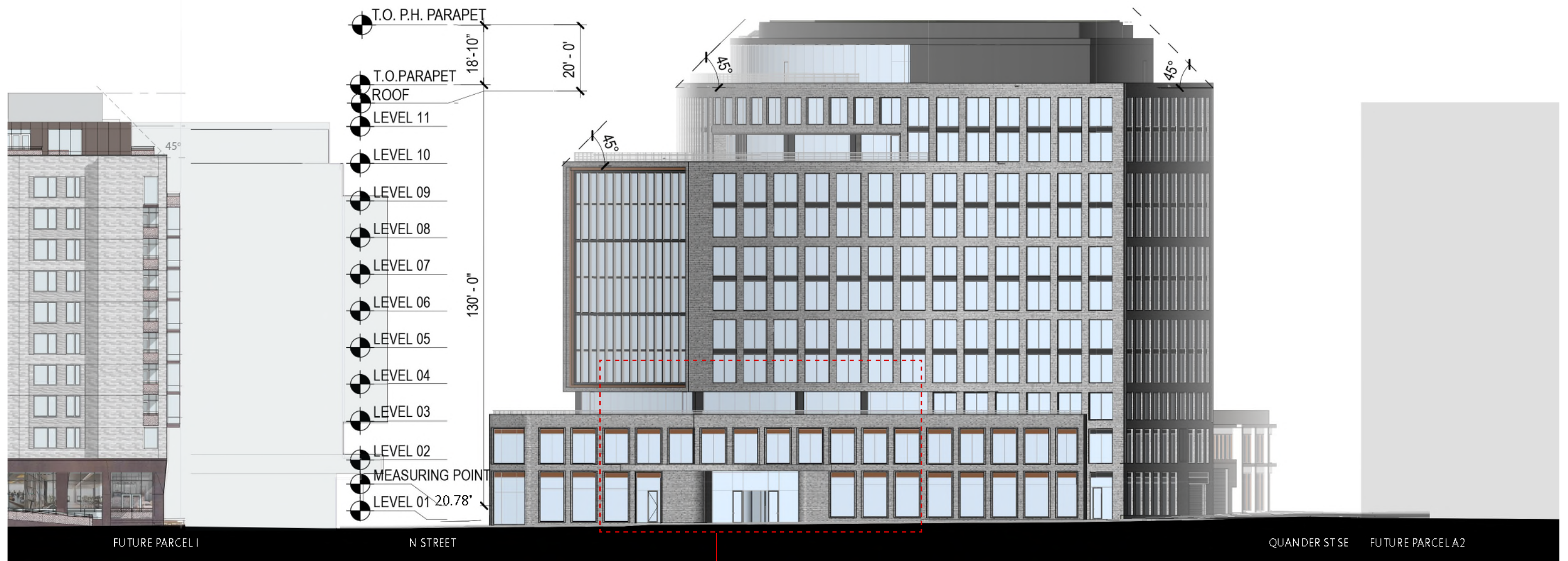
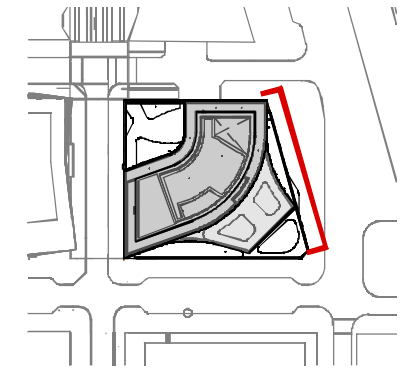

Building Elevation - South

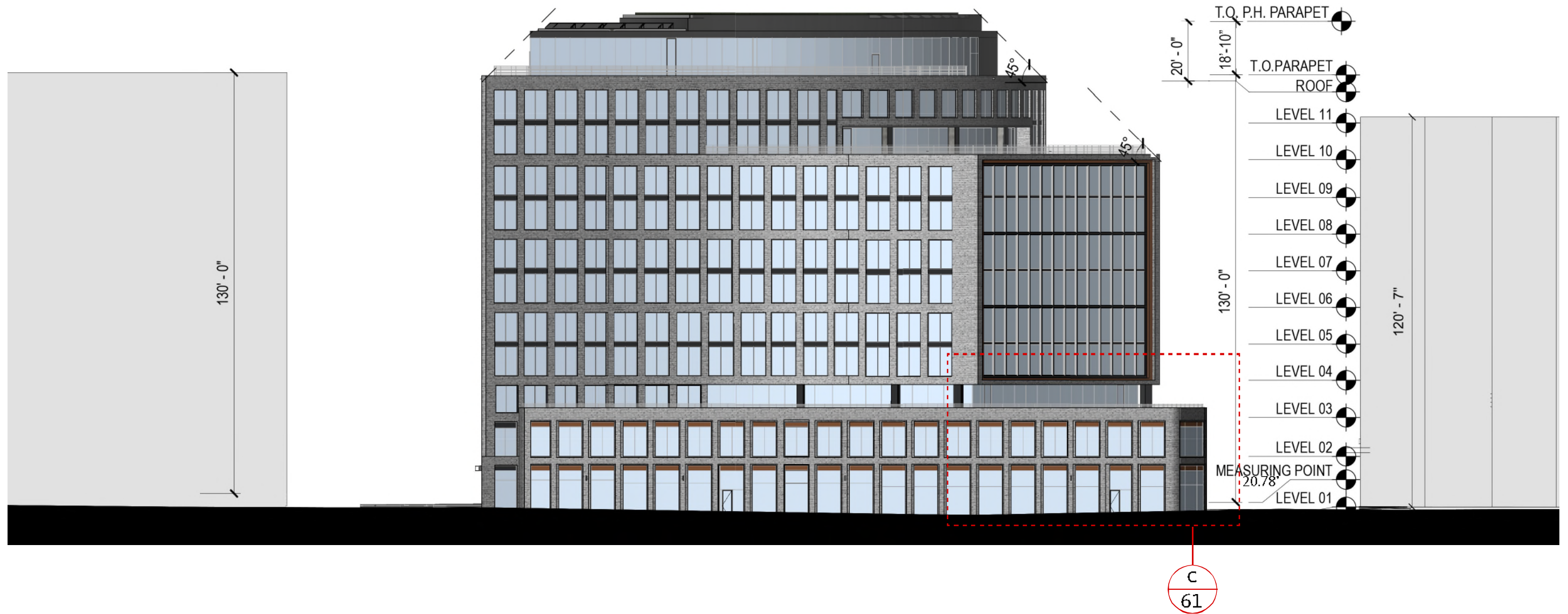
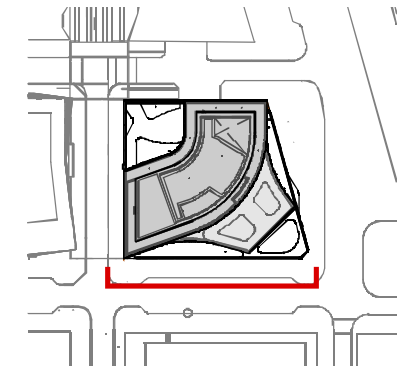

Building Elevation - West

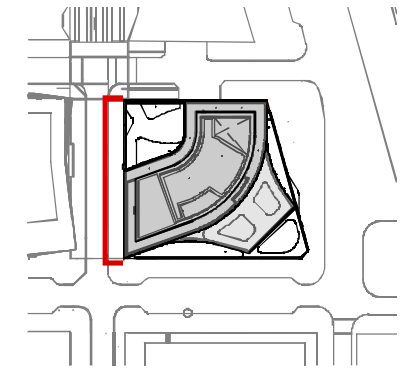
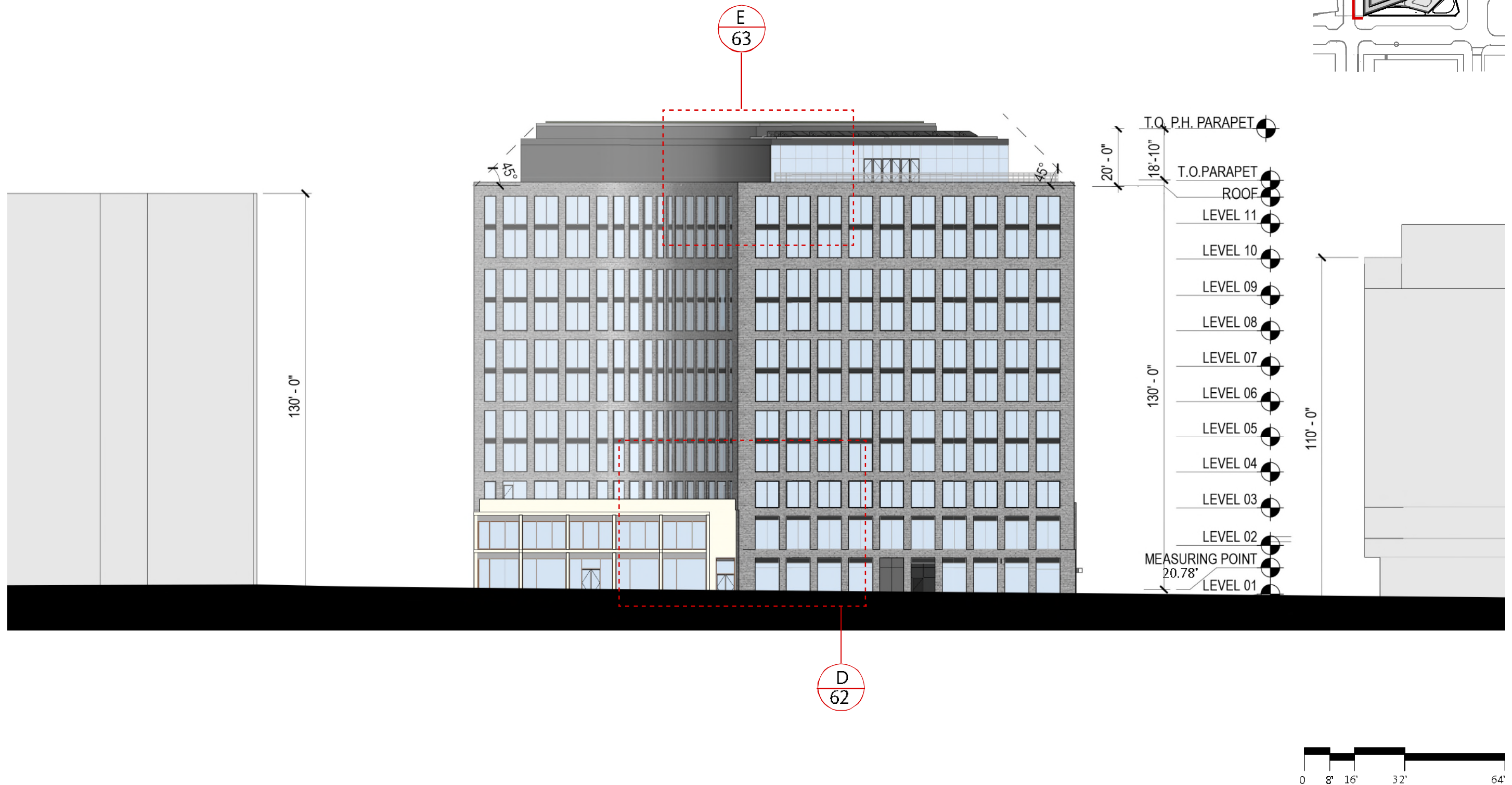

SECTION 5

DESIGN PROPOSAL
Enlarged Elevations

Facade Detail A



Facade Detail B



Facade Detail C

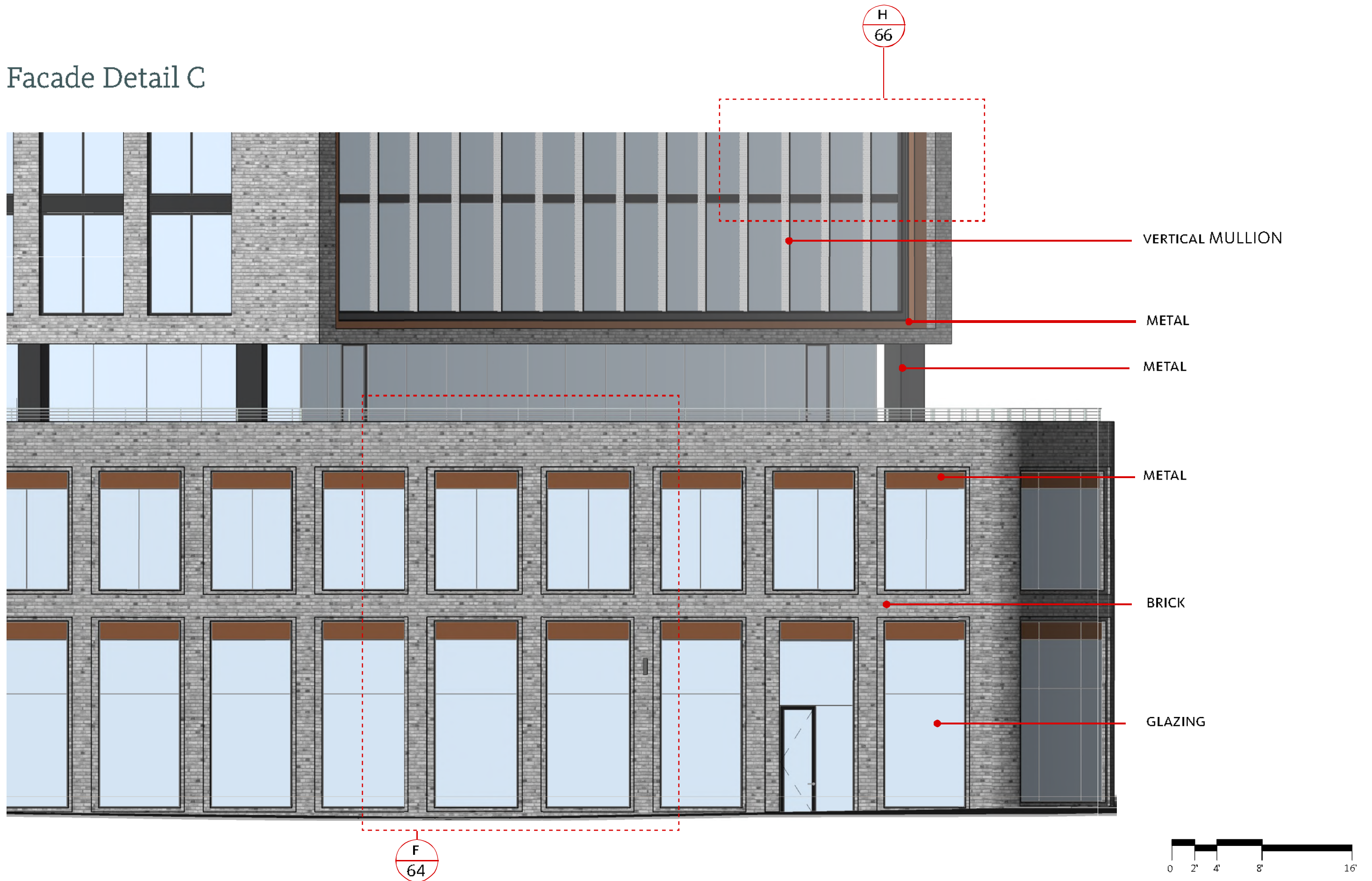

Facade Detail D



J
67

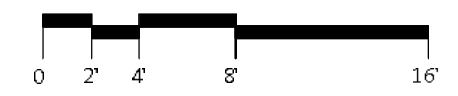

Facade Detail E

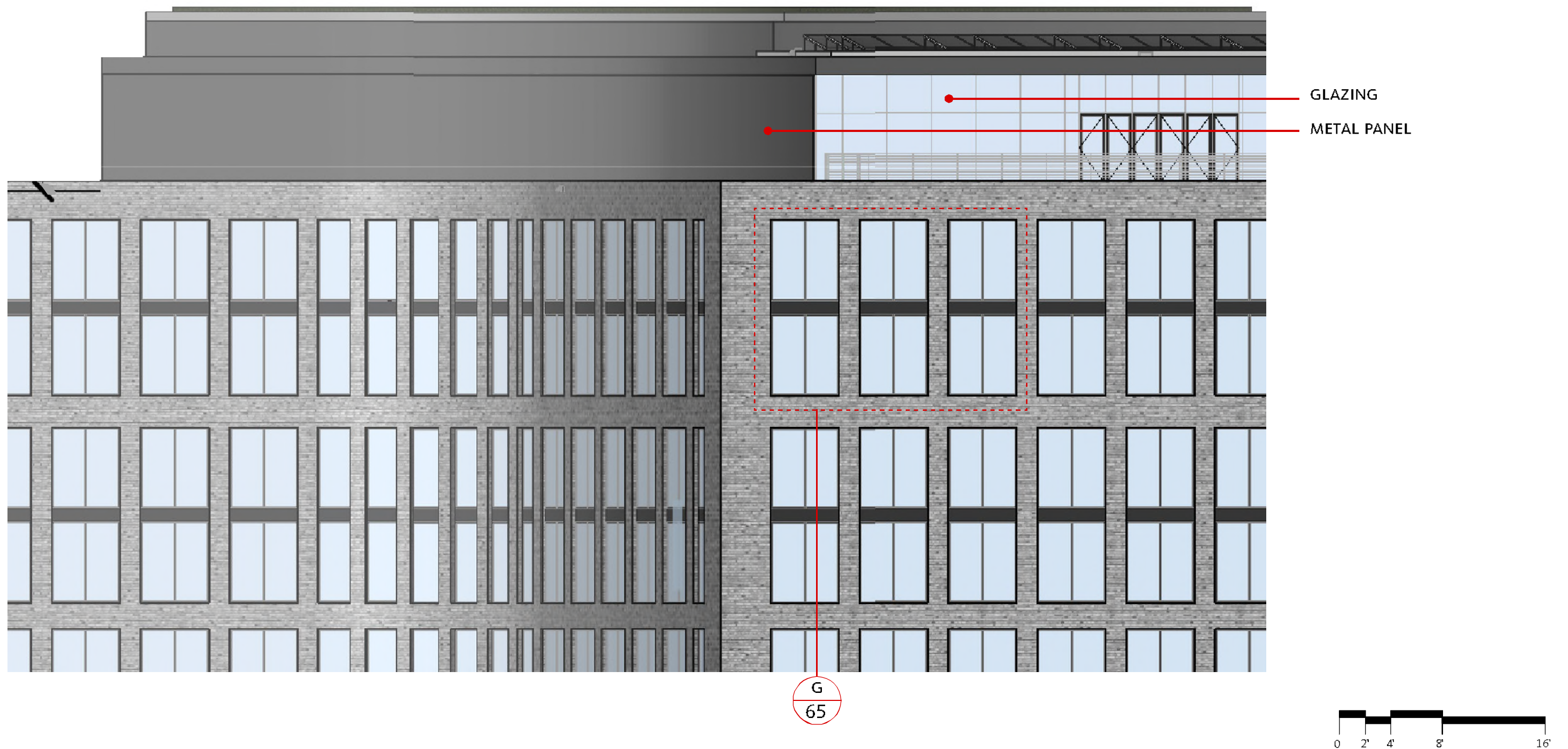

Facade Detail F - Podium

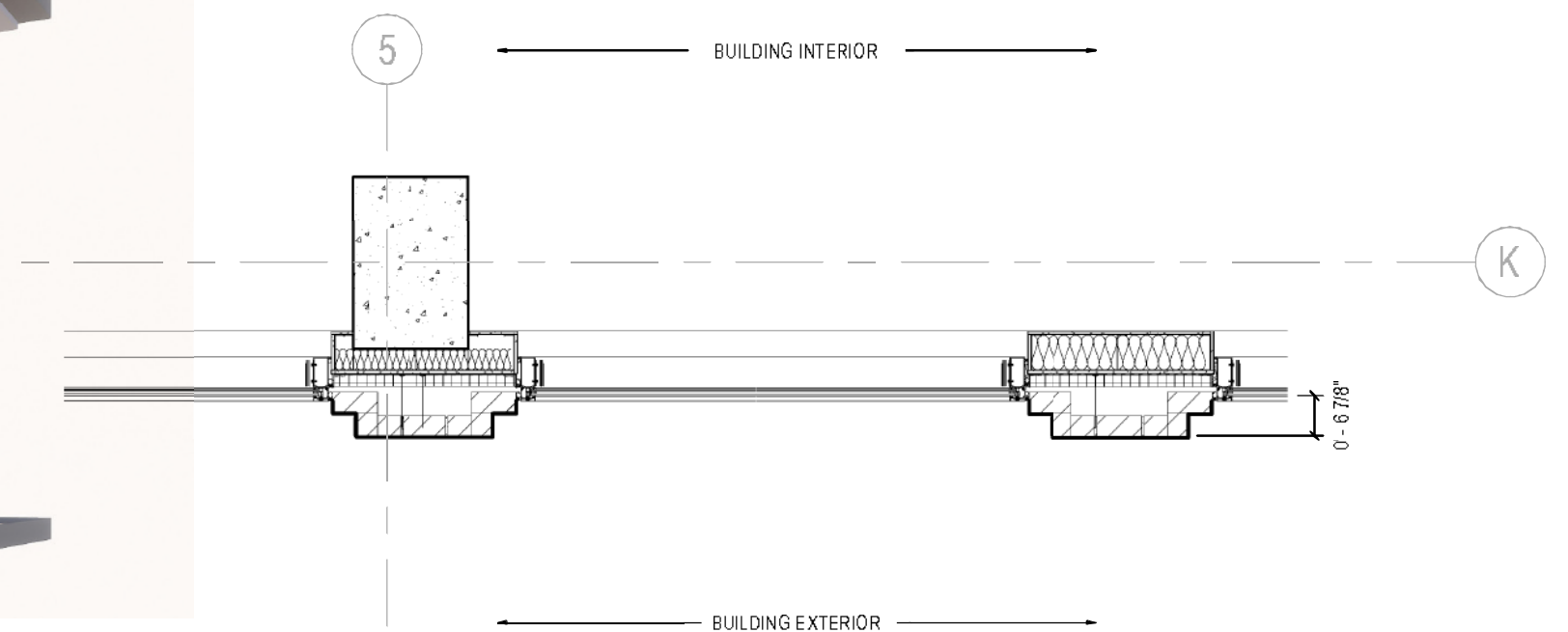

Facade Detail G - Typical Upper Floors

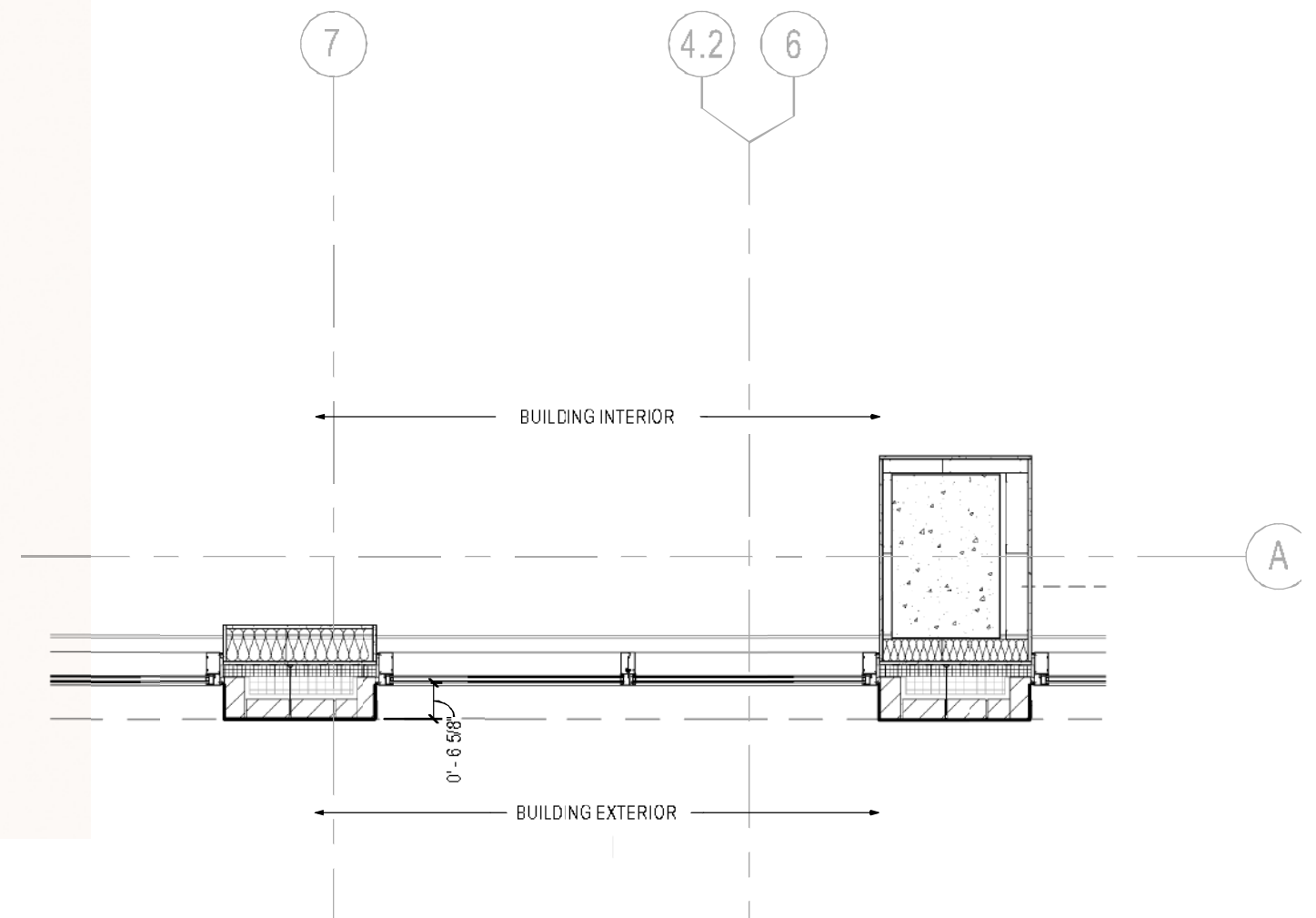
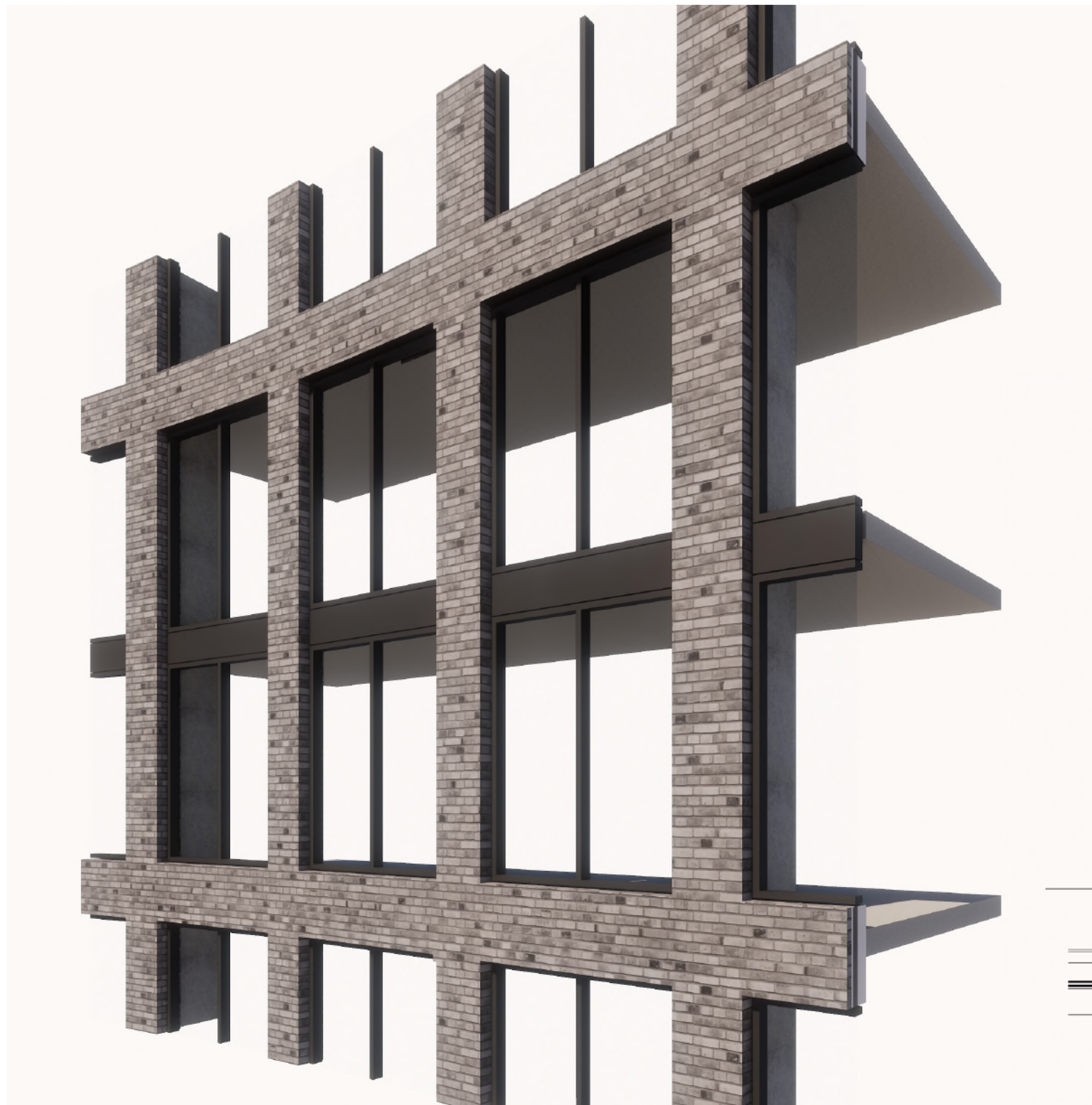

Facade Detail H - Urban Window

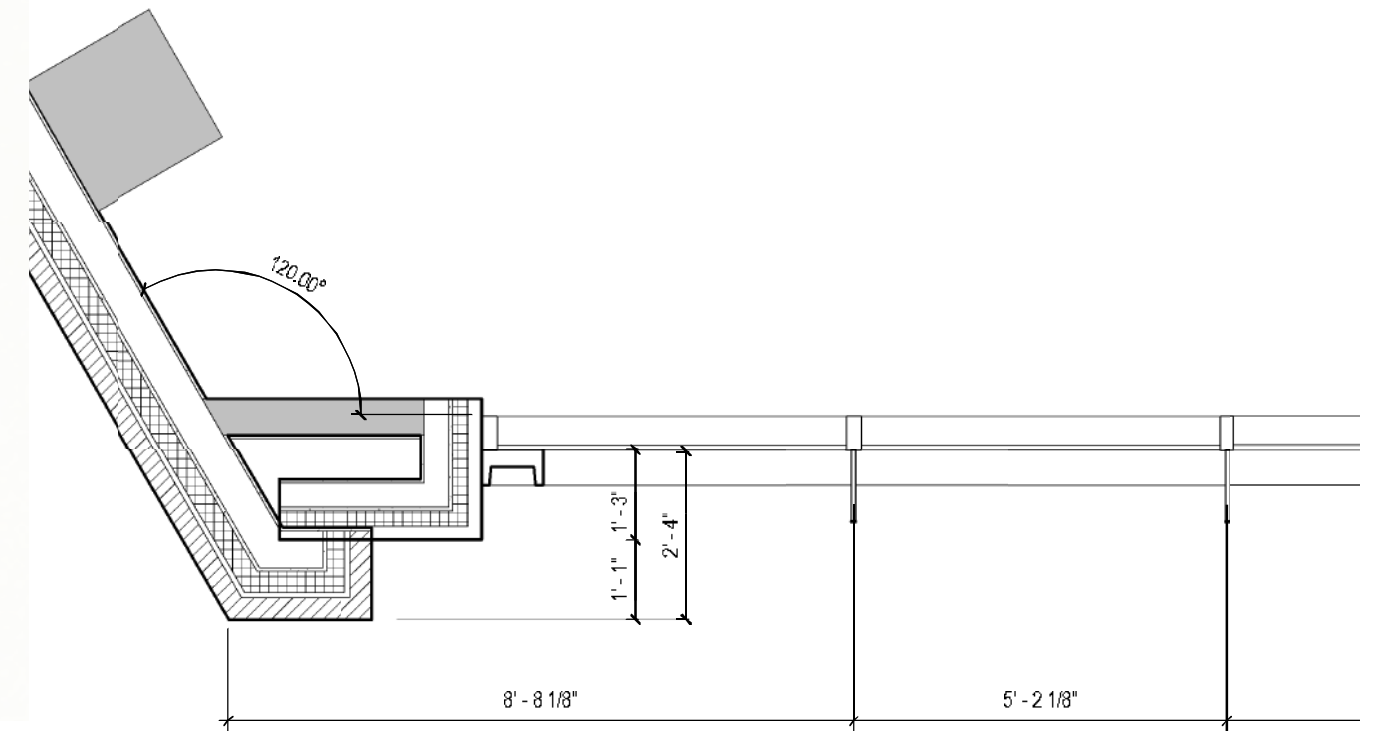

Facade Detail J - Pavilion

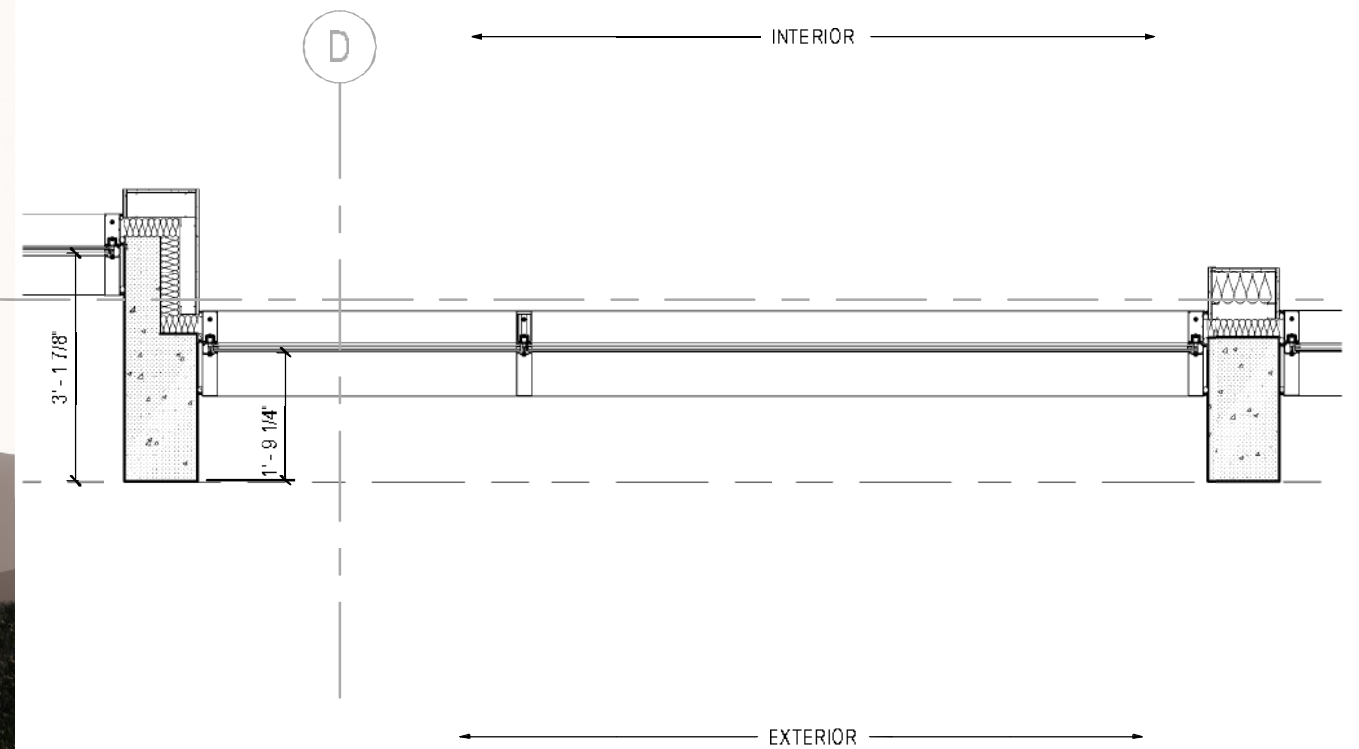

Materials



1. BRICK

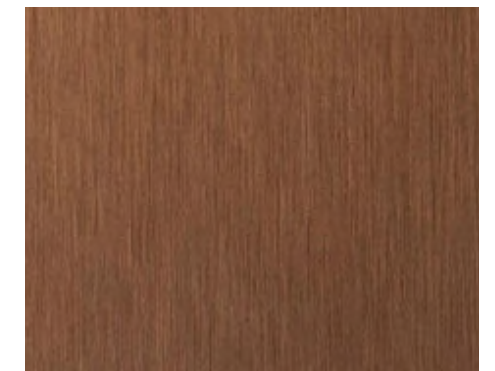

2. METAL

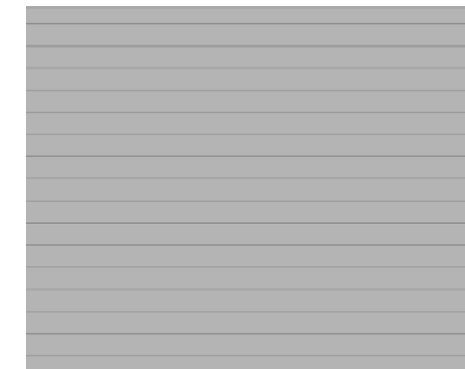

3. RAINSCREEN



4. METAL

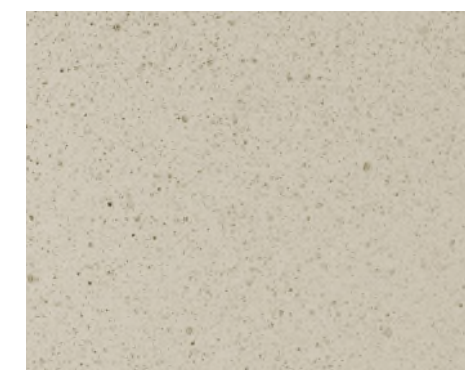

5. PRECAST

Materials



1. BRICK

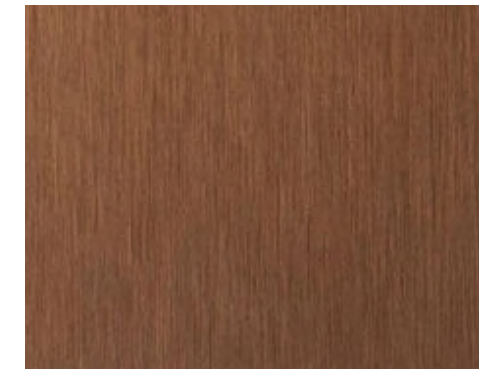

2. METAL



3. VERTICAL MULLION



4. METAL

Materials



1. BRICK

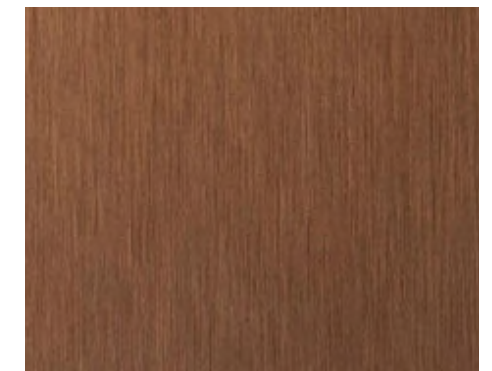

2. METAL



3. VERTICAL MULLION



4. METAL

Materials



1. BRICK



2. METAL



3. ALUMINUM GLAZING SYSTEM